

FOLDABLE LARGE CONTAINER

Experience the convenience of our Foldable Large Container with its collapsible design that saves valuable storage space when not in use. Ideal for shipping and storage, this solution optimizes efficiency and minimizes clutter

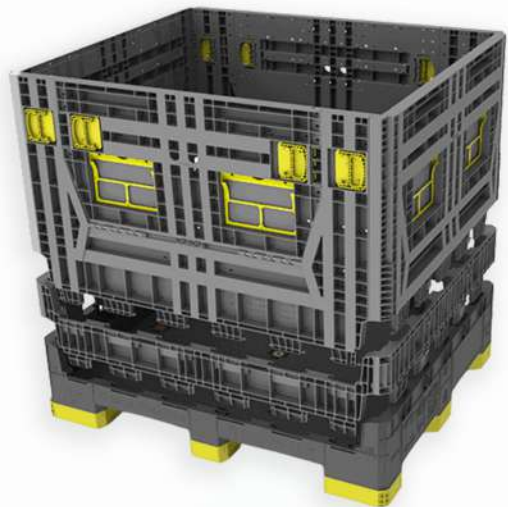

(01) - RIBBED FLC



RIBBED - MODEL II
(EXPANDABLE)

KEY FEATURES - FOLDABLE LARGE CONTAINER

- ✓ Eco - Friendly & Reusable
- ✓ Foldable, Stackable & Collapsible in empty condition
- ✓ Compatible with Material Handling Equipment
- ✓ Enjoy an 70% space - saving in empty condition
- ✓ Wide range of applications



(02) - FLATWALL FLC

CONTACT US

- +91 89256 62224
- Marketing@gnpacks.com

GET IN TOUCH

Green Nest Packaging Solutions,
Featherlite The Address - Tower B, 4th Floor,
200 ft Radial Road, Pallavaram
Thoraipakkam Road, Chennai - 600 044



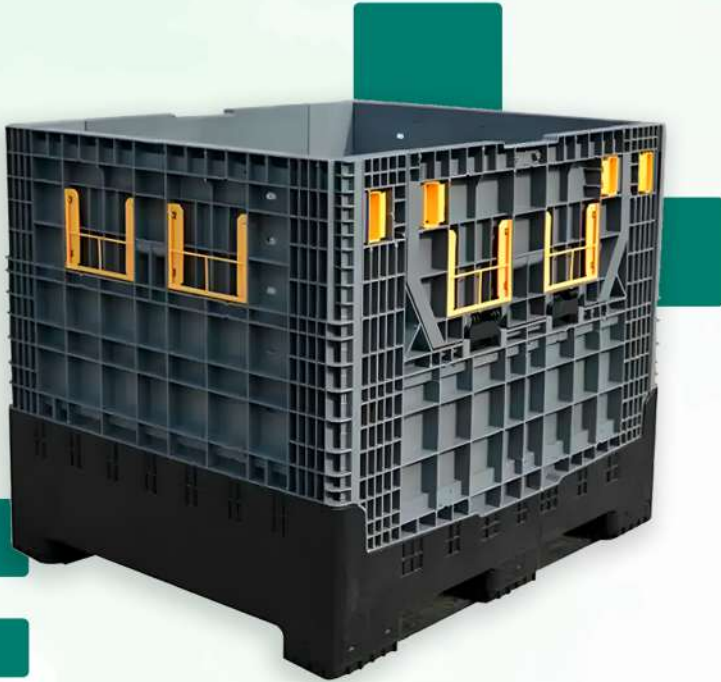

RIBBED FLC WITH TOPLID



RIBBED FLC FOLDED

KEY FEATURES - RIBBED FLC

- ✓ Enjoy an 70% space-saving advantage in empty conditions
- ✓ Features top lid & door options for secure closure
- ✓ Adjustable Height, Stackable in Folded and in Open Condition
- ✓ Nonporous surfaces won't absorb water or dehydrate
- ✓ Lable holders are available on Long Side & Short Side
- ✓ Equipped with Lengthwise Runners & Perfect for Rack Storage
- ✓ Easily handle with a forklift, hand truck, or stacker for convenience

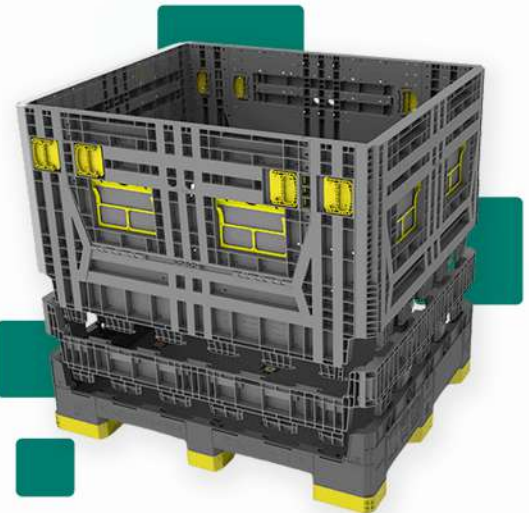

RIBBED FLC - MODEL II
(EXPANDABLE)

OUTER DIMENSION SIZE (MM)	INNER DIMENSION SIZE (MM)	COLLAPSIBLE SIZE (MM)	SELF WEIGHT (KG) (APPROX)	LOAD CAPACITY (KG)	VOLUMETRIC CAPACITY
1200 X 1000 X 1100	1126 X 926 X 944	1200 X 1000 X 308	65 KG	800 KG	986 LTRS
1200 X 1000 X 975	1115 X 910 X 790	1200 X 1000 X 406	65 KG	800 KG	800 LTRS
1200 X 1000 X 595	1115 X 910 X 415	1200 X 1000 X 406	50 KG	800 KG	420 LTRS
DYNAMIC STACKABILITY	STATIC STACKABILITY	TOP LID (OPTIONAL)	DROP DOORS		MATERIAL
G +1 (500 KG / BOX)	G + 3 (500 KG / BOX)	AVAILABLE	DOUBLE DOORS		PP / HDPE



FLC TOP LID



FLATWALL FLC WITH TWO HINGED DOORS



FLATWALL FLC FOLDED

KEY FEATURES - FLATWALL FLC

- ✓ Enjoy an 70% space-saving advantage in empty conditions
- ✓ Equipped with two hinged doors - one on the short side & one on the long side
- ✓ Features top lid options for secure closure
- ✓ Stackable in Folded and in Open Condition
- ✓ Equipped with Lengthwise Runners & Perfect for Rack Storage
- ✓ Easily handle with a forklift, hand truck, or stacker for convenience



OUTER DIMENSION SIZE (MM)	INNER DIMENSION SIZE (MM)	COLLAPSIBLE SIZE (MM)	SELF WEIGHT (KG) (APPROX)	LOAD CAPACITY (KG)	VOLUMETRIC CAPACITY
1200 X 1000 X 975	1140 X 940 X 790	1200 X 1000 X 325	51 KG	800 KG	921 LTRS
1200 X 1000 X 595	1140 X 940 X 410	1200 X 1000 X 295	36 KG	800 KG	439 LTRS

DYNAMIC STACKABILITY	STATIC STACKABILITY	TOP LID (OPTIONAL)	DROP DOORS	MATERIAL
G + 1 (500 KG / BOX)	G + 3 (500 KG / BOX)	AVAILABLE	DOUBLE DOORS	PP / HDPE



OUR NETWORKS

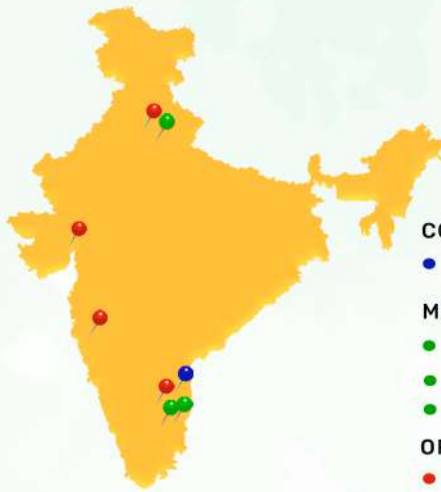

CORPORATE OFFICE

- Chennai

MANUFACTURING UNITS

- Chennai, Unit - I
- Chennai, Unit - II
- Greater Noida

OPERATIONAL CENTRES

- Chennai
- Delhi - NCR
- Pune
- Sanand

OUR CLIENTELE



Sundaram-Clayton Limited



Sundaram Auto Components Limited



OUR OTHER PRODUCTS



PALLET SLEEVE BOXES



FOLDABLE CRATES



RIGID WALL CRATES



REUSABLE PALLETS



WOODEN MOULDED PALLETS



NESTABLE CRATES



METAL SOLUTIONS

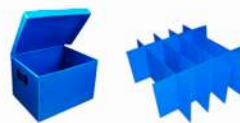

ALL PP CUSTOMIZATIONS



VACUUM FORMED TRAYS

MANUFACTURING PLANT ADDRESS

Green Nest Packaging Solutions
No. 76, Mangalपुरi Nagar, Thirumudivakkam,
Kancheepuram District, Tamil Nadu – 602 109

Green Nest Packaging Solutions,
K407, Site 5, Kasna Industrial Area,
Gautam Buddha Nagar, Greater Noida – 201 308